

Field Service Manual MVF 406 range, 1800 W version



MVF 406, 1800 W cat A1
MVF 406, 1800 W cat A2
MVF 406, 1800 W cat A3
MVF 406, 1800 W cat A4
MVF 406, 1800 W cat A5
MVF 406, 1800 W cat A6
MVF 406, 1800 W cat A7

This is the service manual of the
above mentioned
luminaire.

Field Service Manual

MVF 406 range, 1800 W version

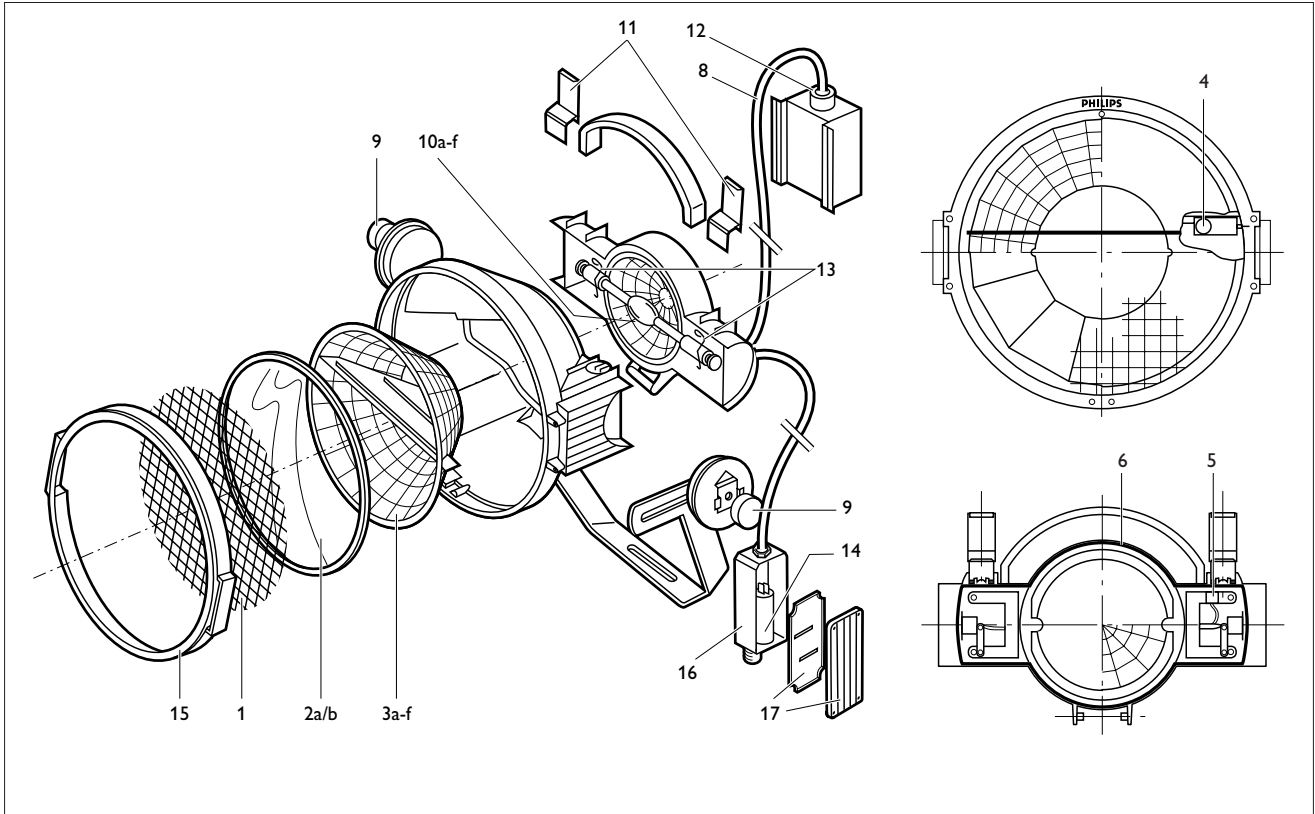

ALUMINIUM TERMINAL BOX VERSION



PLASTIC TERMINAL BOX VERSION

Remark: In the plastic 380/400 V version the ignitor is mounted on the rear housing (see pos. 12)
 In the aluminium 380/400 V version the ignitor is inside the aluminium terminal box (see pos. 14)

Field Service Manual

MVF 406 range, 1800 W version

Item	Ordering number	Qty	Description
1	5322 466 30306	1	Safety net
2a	5322 466 30307	1	Frontglass downlight
2b	5322 466 30384	1	Frontglass up-light
3a	5322 380 10115	1	Front reflector assy cat A1 ²⁾ ⁵⁾
3b	5322 380 10116	1	Front reflector assy cat A2/A3 ²⁾ ⁵⁾
3c	5322 380 10117	1	Front reflector assy cat A4 ²⁾ ⁵⁾
3d	5322 380 10118	1	Front reflector assy cat A5 ²⁾ ⁵⁾
3e	5322 380 10119	1	Front reflector assy cat A6 ²⁾ ⁵⁾
3f	5322 380 10121	1	Front reflector assy cat A7 ²⁾ ⁵⁾
4	5322 405 90821	1	Ass. circ. bridge
5	5322 405 90822	1	Ass. circ. break hous.
6	5322 466 61537	1	Gasket L = 1,111 metre ¹⁾
7a	5322 447 92325	1	Alu terminal box 220-240 V with wiring in tube
7b	5322 526 41102	1	Alu termination box 380-400 V with wiring in tube & ignitor
7c	5322 526 40788	1	Replacement for plastic terminal box with 220-240 V wiring in tube
8	5322 526 41009	1	Wiring set 380-400 V for ignitor IP65 (item 12)
9	5322 462 42149	2	Blue cap
10a	5322 380 20332	1	Rear reflector cat A1/A2 ²⁾ ⁵⁾
10b	5322 380 10122	1	Rear reflector cat A3 ²⁾ ⁵⁾
10c	5322 380 10123	1	Rear reflector cat A4 ²⁾ ⁵⁾
10d	5322 380 10124	1	Rear reflector cat A5 ²⁾ ⁵⁾
10e	5322 380 10125	1	Rear reflector cat A6 ²⁾ ⁵⁾
10f	5322 380 10126	1	Rear reflector cat A7 ²⁾ ⁵⁾
11	5322 492 70168	2	Ass. clip
12	5322 219 82688	1	Ignitor IP65 380 V
13	5322 492 70167	2	Lamp spring
14	5322 219 82687	1	Ignitor 380/415 V
15	5322 532 12427	1	Black alu frame
16	5322 447 92405	1	Empty alu-conn. box
17	5322 447 92403	1	Cover + gasket
18	5322 282 10322	1	Timer for hot restrike 380-400 V ⁴⁾

¹⁾ Gaskets are supplied per metre length. When ordering always state the required length in metres as stated above.

²⁾ Front reflector Cat 1 5322 380 20334 is replaced by front reflector cat A1 5322 380 10115

Front reflector Cat 2 5322 380 20335 is replaced by front reflector cat A2/A3 5322 380 10116

Front reflector Cat 3 5322 380 20336 is replaced by front reflector cat A2/A3 5322 380 10116

Front reflector Cat 4/5 5322 380 20337 is replaced by front reflector cat A5 5322 380 10118

³⁾ Rear reflector Cat 1/2 5322 380 20332 is replaced by rear reflector cat A1/A2 5322 380 20332

Rear reflector Cat 3/4 5322 380 20333 is replaced by rear reflector cat A4 5322 380 10123

Rear reflector Cat 5 5322 380 20411 is replaced by rear reflector cat A6 5322 380 10125

⁴⁾ Mounted on the gear tray

⁵⁾ See the back page for more information.

Field Service Manual

MVF 406 range, 1800 W version

3222 609 26021
10/97
Printed in the Netherlands
Data subject to change

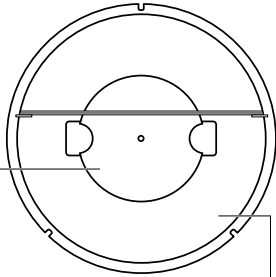

cat A1

Front 5322 380 10115
Rear 5322 380 20332

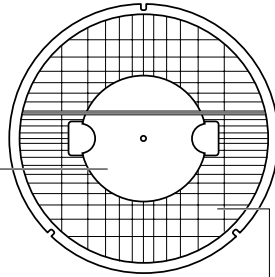

cat A2

Front 5322 380 10116
Rear 5322 380 20332

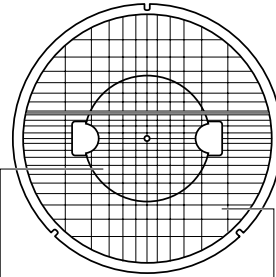

cat A3

Front 5322 380 10116
Rear 5322 380 10122

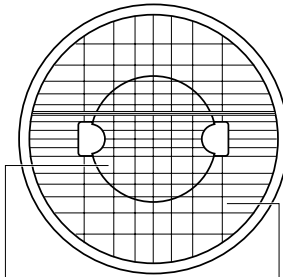

cat A4

Front 5322 380 10117
Rear 5322 380 10123

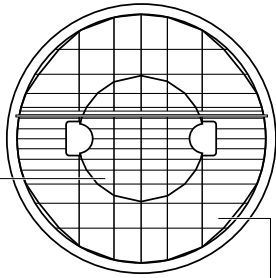

cat A5

Front 5322 380 10118
Rear 5322 380 10124

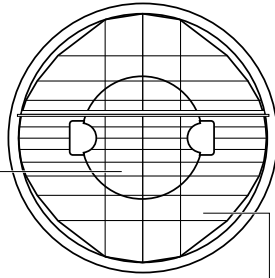

cat A6

Front 5322 380 10119
Rear 5322 380 10125

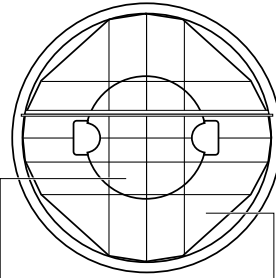

cat A7

Front 5322 380 10121
Rear 5322 380 10126



PHILIPS